

2-2018

SMU will introduce residential learning-and-living concept at Prinsep Street Residences in the new Academic Year 2018-2019

Singapore Management University

Follow this and additional works at: http://ink.library.smu.edu.sg/oh_pressrelease

 Part of the [Asian Studies Commons](#), and the [Higher Education Commons](#)

Citation

Singapore Management University. SMU will introduce residential learning-and-living concept at Prinsep Street Residences in the new Academic Year 2018-2019. (2018). 1-4. SMU Press Releases.

Available at: http://ink.library.smu.edu.sg/oh_pressrelease/152

This Transcript is brought to you for free and open access by the University Heritage at Institutional Knowledge at Singapore Management University. It has been accepted for inclusion in SMU Press Releases by an authorized administrator of Institutional Knowledge at Singapore Management University. For more information, please email libIR@smu.edu.sg.



Media Release

SMU will introduce residential learning-and-living concept at Prinsep Street Residences in the new Academic Year 2018-2019

Singapore, 12 February 2018 (Monday) – In the new academic year (AY) 2018-2019 starting August this year, SMU will introduce a new residential learning-and-living concept at its existing student residence – Prinsep Street Residences (PSR). At PSR, SMU aims to build a community for the Community, where students co-live/work/learn together, and are also nurtured to be change agents by giving back to the Bras Basah community.

Staying true to SMU's hallmark holistic approach to education, the University will offer programming guided by five themes – (i) Entrepreneurship, (ii) Social Entrepreneurship, (iii) Community Service, (iv) Grooming Future Leaders, and (v) Social Integration and Diversity. Through this thematic approach, PSR will provide a supportive environment that will nurture well-rounded students with strong *esprit de corps*, as they collaborate in projects and activities to make a meaningful impact in their immediate communities.

Professor Lily Kong, SMU Provost, said, "The SMU residential living-and-learning model is very much an extension of our holistic approach towards education, which has been a hallmark since SMU's inception in 2000. As a university, we are committed to nurturing well-rounded students who will make a meaningful impact in their communities. We are confident that students will benefit richly from the residential experience, while contributing to the larger community around them."

"SMU already offers a vibrant student life experience, with over 120 student clubs and an exciting co-curricular calendar throughout the year. PSR will be another platform through which students will have the opportunity to pursue an enriching, meaningful and unique residential experience in the heart of the city. Residential life will be enriched with academic curriculum as well as student-directed projects and activities. Through these learning opportunities between the community and the classroom, students will build character, develop life-skills and forge friendships for life," Professor Kong added.

Refurbishment works are currently underway at the PSR estate, located about 650 metres (or 8 minutes by foot) from the SMU campus. When completed in July 2018, PSR will offer 23 large-sized shared apartments for 255 student residents, as well as purpose-built communal spaces that will facilitate and support co-living/working/learning. The PSR residential population will comprise undergraduates from across all four years of study, and a mix of Singaporean and international students.

In line with SMU's commitment towards developing a smart, green and sustainable campus, several new technology and green features are being integrated with innovative smart building technology, so as to enhance energy efficiency and human comfort. The efforts are expected to bring about significant energy savings of approximately 45-50 per cent per year.

SMU's care for the environment goes further with conscious reuse and recycling efforts. For example, key infrastructure such as existing electrical power lines, plumbing and sanitary network were assessed to be in good condition and retained with minor enhancements, thus avoiding wastage and unnecessary rework. Also to be reused are the existing security network, CCTVs, fire alarm (robustness ensured), chairs and water dispensers. Some used wall-mounted fans are being retained while others will be redeployed to other parts of the SMU campus. The used air-conditioning split units were traded-in for reuse at other construction sites. Mattresses found to be in good condition were distributed to charitable organisations, while the remaining ones were repurposed in construction work, i.e. used to cushion the impact from the hacking works and to mitigate the noise arising from hacking works.

- End -

Enclosure:

- Annex 1 – Artist's impressions of Prinsep Street Residences

About Singapore Management University

A premier university in Asia, the Singapore Management University (SMU) is internationally recognised for its world-class research and distinguished teaching. Established in 2000, SMU's mission is to generate leading-edge research with global impact and produce broad-based, creative and entrepreneurial leaders for the knowledge-based economy. It is known for its interactive and technologically enabled pedagogy of seminar-style teaching in small-size classes.

Home to around 10,000 undergraduates and postgraduates, SMU comprises six schools: School of Accountancy, Lee Kong Chian School of Business, School of Economics, School of Information Systems, School of Law and School of Social Sciences. SMU offers a wide range of bachelor's, master's and PhD degree programmes in the disciplinary areas associated with the six schools, as well as in interdisciplinary combinations of these areas.

SMU has an emphasis on generating rigorous, high-impact, and relevant multi-disciplinary research that addresses Asian issues of global relevance, SMU faculty collaborate with leading international researchers and universities from USA, Europe, China and India as well as with partners in the business community and public sector, through its research institutes, centres and labs. SMU's city campus is a state-of-the-art facility located in the heart of downtown Singapore, fostering strategic linkages with business, government and the wider community. www.smu.edu.sg

Media Contact

HUANG Peiling (Ms)
Senior Assistant Director, Corporate Communications
SMU Office of Corporate Communications & Marketing
Tel: (65) 6828 0964 / (65) 9845 3361
Email: plhuang@smu.edu.sg

Annex 1

Artist's impressions of refurbished Prinsep Street Residences (PSR)

- **Prinsep Street Residences Estate**



With three four-storey blocks of flats dating back to Singapore's early pre-HDB days, the refurbishment project aims to retain the original flavour of the apartment through sensitive intervention, and provide a fresh yet natural and compatible take on the original architecture.

The refurbished PSR estate will see a hybrid of old and new structures interplay and contrast with each other – the new glass lounge and double volume trellis provides an artistic look and feel to these blocks.

- **Multi-purpose Lounge**



The space between two existing blocks provides an attractive and exciting opportunity to create an integrated communal hub for students. From this intersectional space, two strikingly different volumes are carved out of glass, timber and steel, allowing natural sunlight and breeze to infiltrate and permeate the area.

- **Apartment**

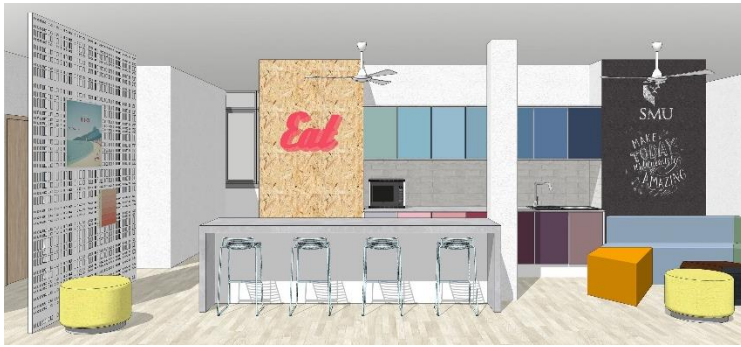

In line with the growing popularity of communal co-live/work/learn housing among millennials, PSR apartments offer generous living areas which open up opportunities for community meals, movie nights, birthday celebrations and other social networking opportunities.

Privacy is nonetheless emphasised within fully air-conditioned bedrooms featuring integrated design solutions which maximise space, and vibrant wall colours which inject a sense of character and fun to these spaces.

- **The Cafe**



The student-operated café and lounge space will not only allow residents to purchase snacks and refreshments, but also encourage entrepreneurial qualities in students.

The space is designed to be flexible and transformable, with moveable counters and furniture, thus liberating the floor plan for multiplicity of student use. When the café is not in use, the floor plan can be transformed into a seminar hall or an indoor dance studio.

Important to note: For image credit, please use 'Singapore Management University' or 'SMU'.